

WHITE INK PRINTING



IMPROVED PERFORMANCE FOR BACKLIT PRINTING APPLICATIONS

WHITE INK PRINT ENHANCEMENTS

Printing on transparent media is made possible by the application of white ink as an under or over layer.

Day & Night Printing on Backlit Materials

[Colour & White & Colour 3 layers]
Printing a white layer between coloured layers, ensures a consistent result whether illuminated or not.

[Colour & Colour 2 layers]
If only 2 layers of coloured ink are applied, the resulting image is too dark when viewed in daylight.

White ink circulation technology MCT (Mimaki Circulation Technology)

By periodically circulating white ink in line from tank to head, pigment deposition is prevented. MCT ensures stable production and reduction of ink discharge and waste.

INLINE LIGHTBOX

INLINE LED LIGHTBOX FOR BACKLIT PRINT INSPECTION

Proofing while printing LED backlights illuminate printed media just after printing, reproducing a backlit signage application and ensuring immediate quality inspection.

- No need to stop the printer to check.
- LED lights set in the space after print platen enabling immediate correction if errors occur
- Saves time, ink and media.

- Colour temperature: 7,000 Kelvin
- Brightness easily adjustable.
- LED lights can be removed from the printer.

BACKLIT PRINTING

HIGH 'BLOCKOUT' PERFORMANCE FOR BACKLIT SIGNAGE

A key feature of UV-curable ink is the thickness of the ink layer on the media, which enables much greater 'blockout' performance than other print methods.

This is particularly beneficial in backlit signage applications where the ability to block out backlighting in certain areas improves overall illuminated colour performance and vibrancy.

Sophisticated RIP software maximizes the performance of UJV55-320

User friendly RIP "RasterLink 6" comes as standard

RasterLink 6

- More beautiful and advanced print results are achieved by following a user-friendly interface that is easy to operate.
- Colour replacement function enhances the ability to re-create printed images.
- Print colour can be simulated on Illustrator / Photoshop without an actual print.
- The function ensures MIMAKI's stable waterjet.
- Program update and profile download can be easily performed via internet.

New image-processing technique reduces tone jumps and uneven colour printing

Mimaki Fine Diffusion 1 (MFD1) has been recently added to the bundled RasterLink6 RIP software. MFD1 reduces the noise that is generated in image data during image processing and enables the production of better print results without tone jumps or uneven colours.

UJV55-320

Specifications

Item	UJV55-320	
Head	On-demand piezo head (4 printheads / in 2 staggered array)	
Print resolution	300dpi, 600dpi, 900dpi, and 1200dpi	
Ink droplet size	Minimum: 7pL Maximum: 36pL	
Head gap (Manual adjustment)	1.7mm / 1.9mm / 2.6mm / 3.3mm	
Ink	Type	UV LED ink LUS-120
	Colour	4 - Colour (C, M, Y, K) / 7 - Colour (C, M, Y, K, Lc, Lm, W)
	Packaging	1 litre ink bottle, ink can be filled up to 3 litres per ink colour.
Maximum print width	3,200mm	
Maximum media width	3,250mm (Twin rolls printing: 1,524mm x 2)	
Minimum media width	210mm	
Media thickness	1.0mm or less	
Roll outer diameter	Large drive shafts: Φ250mm or less. Small media roll holders: Φ180mm or less.	
Roll weight	Large drive shafts: 100kg or less. Small media roll holders: 25kg or less	
Dimensions (W x D x H)	5,410mm x 995mm x 1,440mm	
Shipping dimensions (W x D x H)	5,714mm x 1,136mm x 1,203mm	
Machine weight	910kg	
Power supply	AC 200 - 240V ± 10% 50/60 Hz ± 1 Hz, 18 A or less. * 100V Power not available	
Power consumption	4.3kVA or less	
Operational environment	Temperature	20 - 30 °C (68 - 86 °F)
	Humidity	35 - 65%RH (No condensing)
	Temperature accuracy	20 - 25 °C (68 - 77 °F)
	Temperature gradient	Less than ± 10 °C/h (± 18 °F/h)
	Dust	0.15mg/m ³ (Equivalent to normal office level)

Supplies

Item	Colour	Item No.	Remarks
UV LED ink LUS-120	Cyan	LUS12-C-BA-1	1L bottle
	Magenta	LUS12-M-BA-1	
	Yellow	LUS12-Y-BA-1	
	Black	LUS12-K-BA-1	
	Light Cyan	LUS12-LC-BA-1	
	Light Magenta	LUS12-LM-BA-1	
	White	LUS12-W-BA-1	
Flushing Liquid	FL007-Z-BA-1-KA		



3.2m Grand format UV LED printer ...

* Some of the samples in this folder are artificial renderings - Specifications, design and dimensions stated in this folder may be subject to change without notice (for technical improvements, etc.)
* The corporate and merchandise names written on this folder are the trademark of the respective corporations - Inkjet printers print using extreme fine dots, so colours may vary after replacement of the printing heads, also note that if using multiple printer units, colours could vary slightly from one unit to other unit due to slight individual differences - Compositor's errors reserved

id numerique
23 avenue Paul Duplaix
Z.I du Prat - 56000 VANNES
02 97 01 22 90
www.idnumerique.fr

Mimaki

www.mimakieurope.com info@mimakieurope.com MimakiEurope

Mimaki Europe B.V. Stammerdijk 7E, 1112 AA Diemen, The Netherlands Tel: +31 (0)20 4627640



Mimaki

The world imagines... Mimaki delivers



the power to create



High performance grand format LED UV inkjet printer

The all new Mimaki UJV55-320 grand format LED UV inkjet printer delivers a unique combination of high quality super wide output for volume production of banners, retail, exhibition and window graphics and other similar applications up to 3.2m wide, with the added versatility of twin-roll simultaneous printing.

ENGINEERING EXCELLENCE
AND CREATIVE INNOVATION

Founded in Japan in 1975, Mimaki Engineering has steadily grown by reputation and influence into a global company with large operational bases in Asia and the Pacific, United States and Europe.

Renowned for award-winning performance, peerless build quality and innovative technology, Mimaki has established itself as a leading manufacturer of wide-format inkjet printers and cutting machines for the sign and graphics, textile and apparel and industrial markets. In addition, Mimaki also provides a comprehensive range of supporting products; hardware, software and associated consumable items, such as inks and cutting blades.

From outdoor signage and billboards to interior decoration and furnishing, from packaging and labels to promotional gifts and apparel, Mimaki is committed to developing technology that sets new industry standards, producing machines and products that turn the imagination of our customers into breath-taking reality.

... Mimaki delivers

UJV55-320 delivers ...

- Super wide format printing (up to 3.2m)
- High speed printing up to 110m²/h
- Newly developed LUS-120 high performance UV curing ink including white
- High density print mode for front/backlit applications
- Inline LED Lightbox for backlit print inspection
- MAPS, MFD1, NCU & NRS for optimal print quality & performance
- Simultaneous twin-roll print facility
- Media roll weights up to 100kg

- NEW LUS-120 LED UV 4 and 7 COLOUR INKSET
- 110m²/h MAX. PRINT SPEED
- 1200DPI MAX. RESOLUTION
- 3,200mm MAX. PRINT WIDTH
- RASTERLINK 6 RIP SOFTWARE
- 3 LITRE INK TANKS

UJV55-320



Efficient and Versatile Twin-Roll Simultaneous Printing
Taking advantage of the 3,200mm printing width, two media rolls can be mounted for simultaneous printing. Different print jobs (or the same print job) can be printed on two separate rolls. The user can select the preferred width separately for each roll, within a specified range (210 to 1,524mm).

Prevention of print quality problems - NCU*
The UJV55-320 is equipped with Mimaki's original automatic NCU. Clogged nozzles are automatically detected and cleaned by the NCU. If the clogging is not resolved by cleaning, the UJV55-320 automatically sets the nozzle recovery function NRS and resumes printing. These functions significantly reduce the waste printing caused by clogged nozzles during a continuous printing run.

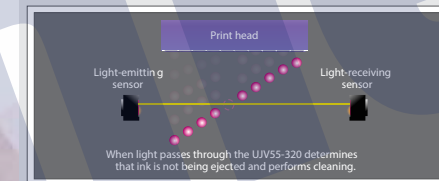

Productivity maintenance - NRS* 1
The NRS substitutes defective nozzles with non-defective nozzles until the technician arrives. This feature enables uninterrupted print operations and continuous productivity.

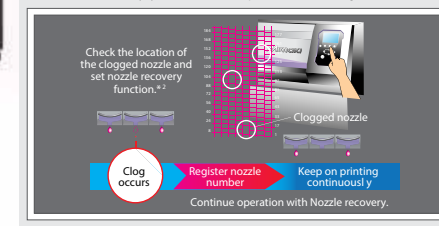

EASE OF USE

KEY TECHNICAL FEATURES ...

PRINT QUALITY

4 colours -- CMYK

7 colours -- CMYKLCmW

IMPROVED PRINT HEAD CONFIGURATION

Head configuration: Four print heads in a staggered array.
1 head : 1,280 nozzles (320 nozzles X 4 lines)
4 head s : total 5,120 nozzles

BEAUTIFUL OUTPUT

MAPS (Mimaki Advanced Pass System)
Reduces banding by dispersing ink drops between passes.

Waveform Control Technology
Ensures high quality print resolution, by jetting ink drops in straight lines with almost perfect round dots, delivering clear and sharp letters, lines and edges.

Superior inkjet technology
Delivers high density print by removing the gap between dots.

Maximum dot size = 36pl
1/360 inch
High density as no gap between dots
Suitable for High speed mode

